

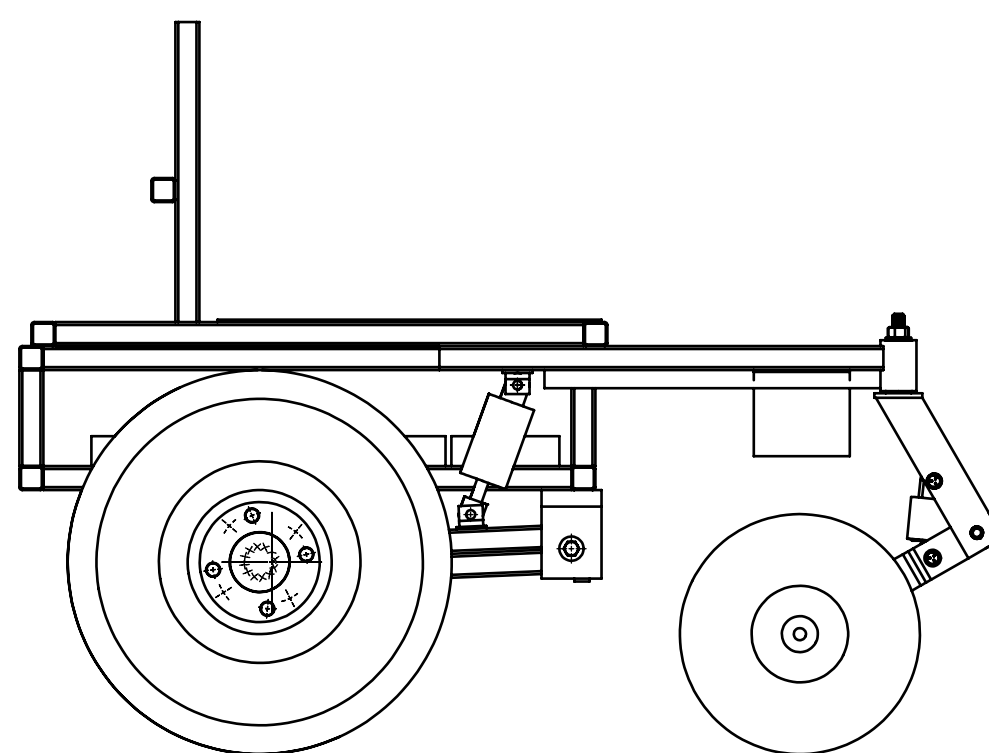

REV	DESCRIPTION	ECO	DATE	BY

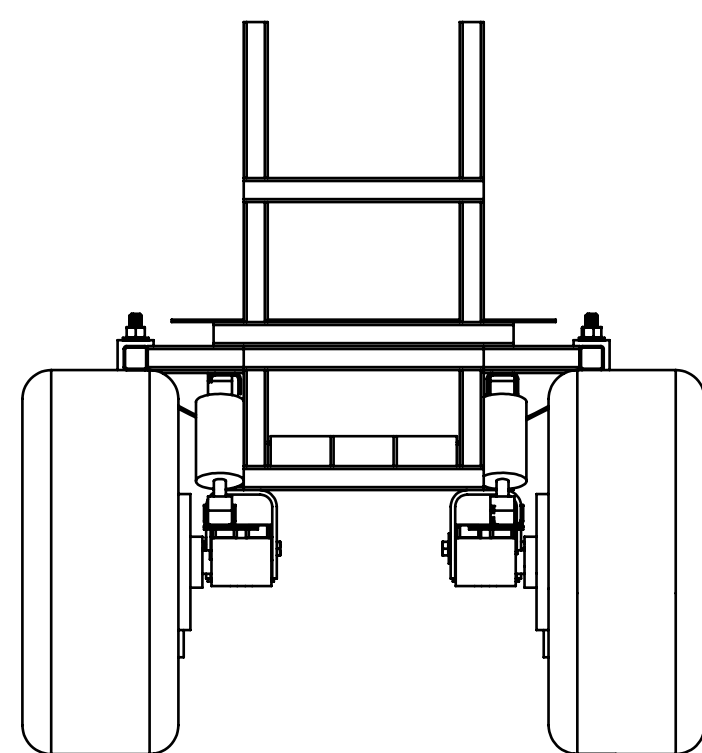
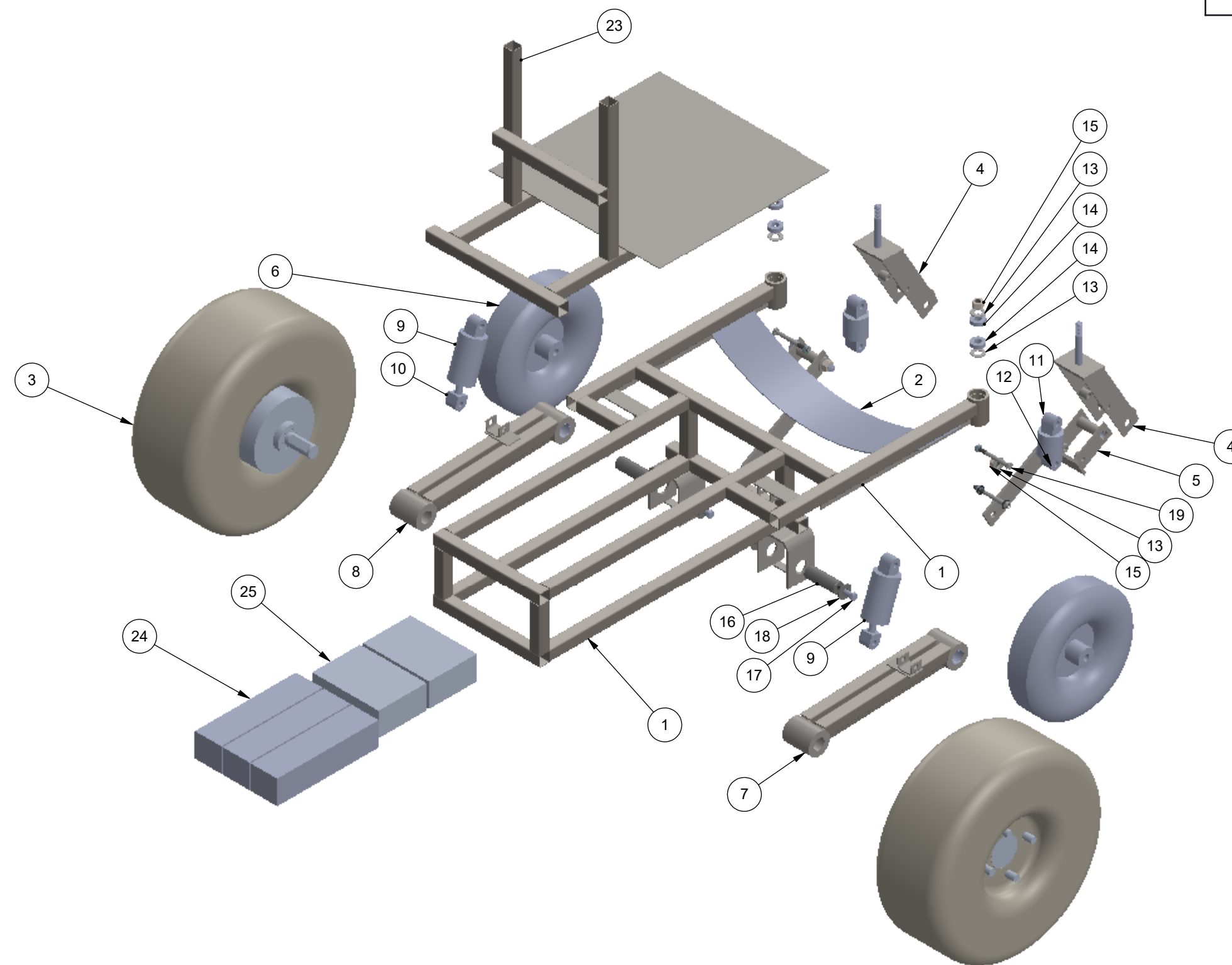

APPROX. WEIGHT 129.54 LBS.

ITEM	PART NUMBER	QTY.	DESCRIPTION
25	5010002	2	CONTROLLER, MOTOR
24	5010001	3	BATTERY 48 V DVC
23	2010008	1	SEAT ASM
22	050 x 350 bolt	2	BOLT .50 X 3.50
21	1010029	4	NUT 5/16-18 HEX
20	1010028	4	WASHER FLAT .312
19	031 x 300 bolt	4	SCREW HHC 5/16-18 X 2.5" GR 8
18	16-1005	4	WASHER FLAT 3/8 SAE
17	037 x 075 bolt	4	BOLT 3/8-16 X .75
16	1010026	2	FRONT SWING ARM PIVOT BAR
15	2010000625 NUT	4	HEX NUT 1/2"- 13- GRADE 8
14	60355K691_Ball Bearing	4	CASTER BALL BEARING
13	16-1034 WASHER	6	1/2" SAE WASHER FLAT
12	front shock rod	2	FRONT SHOCK
11	front shock body	2	FRONT SHOCK
10	rear shock rod	2	REAR SHOCK
9	rear shock body	2	REAR SHOCK
8	3010002-A	1	SWING ARM LH, RH
7	3010002-A	1	SWING ARM LH, RH
6	wheel 10 asm	2	WHEEL FRONT 10"
5	3010001	2	FRONT CASTER LOWER ASM
4	2010005	2	FRONT CASTER TOP WELDMENT
3	wheel motor ass 16	2	WHEEL MOTOR ASM 16" WHEEL
2	sling	1	SLING
1	2010003	1	FRAME WELDMENT

DO NOT SCALE	DESCRIPTION	REV	DATE	BY	ECO #
	MATERIAL				
	SIZE	PROJECTION	LEGEND	REVISION	TOLERANCES
	<p>UNLESS OTHERWISE SPECIFIED</p> <p>X ± .1 BREAK ALL</p> <p>XX ± .030 SHARP</p> <p>XXX ± .015 EDGES .005/.030</p> <p>ANGLE ±1° FINISH RMS 125</p>		<p>DATE:</p> <p>ESR:</p>		
TOTAL NO. OF USED		SIMILAR TO:		PART NUMBER	
				<p><b>wheelchair asm</b></p>	
				<p>SCALE: 1:8 UNITS: INCHES [mm] SHEET 2 OF 2</p>	